

THE SPIRE

FIRST UNITED METHODIST CHURCH
IN PRATT, KS

135TH YEAR OF MINISTRY

JANUARY 2020 NEWSLETTER

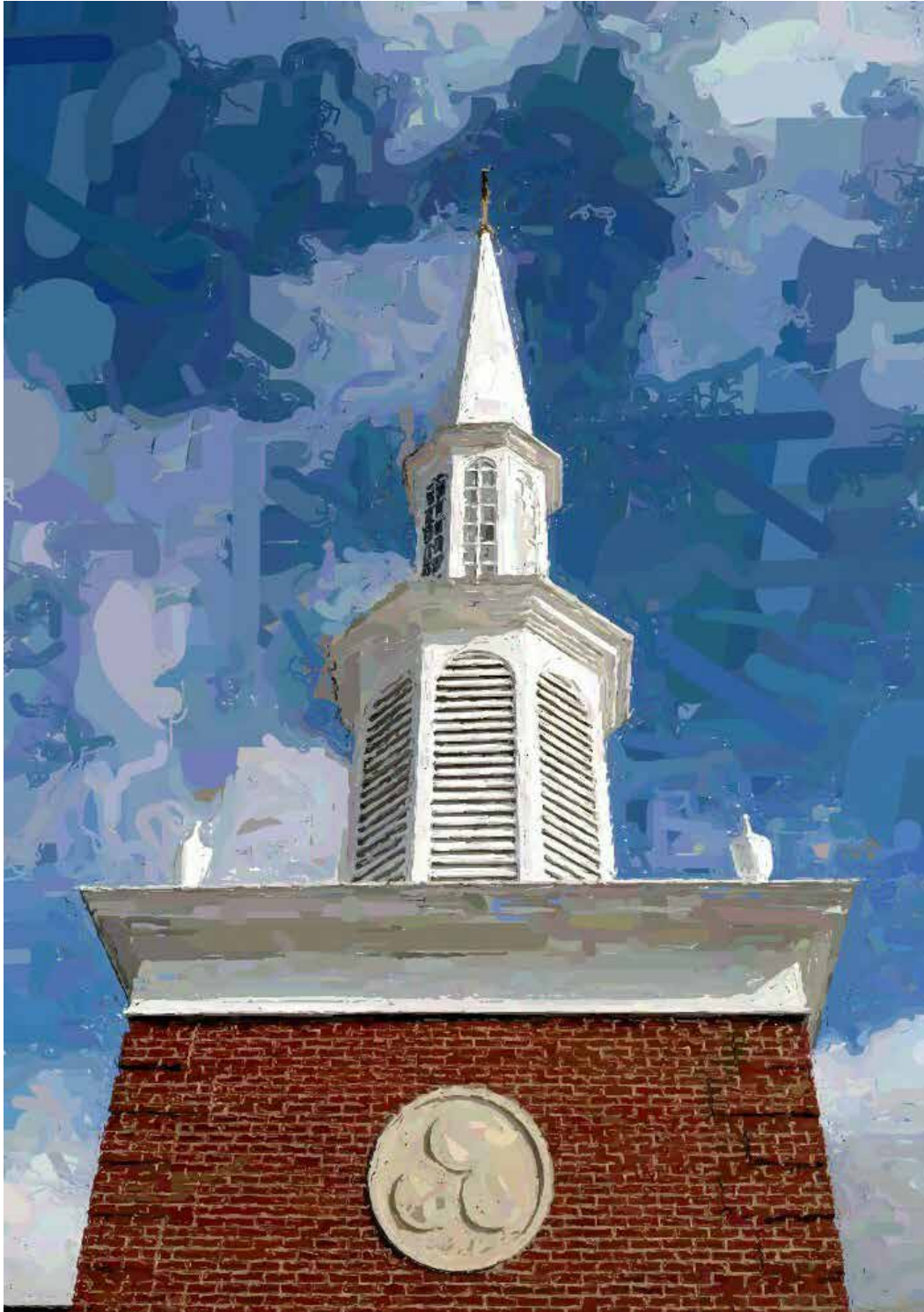

Do You Have 2020 Vision?



Well, here we are, staring a new year in the face. Is 2020 going to be just another year in the life of the First United Methodist Church of Pratt? Is it going to be just another year in your life? Or do you have visions of God doing wonderful things in our lives, both individually and corporately?

It's easy to look back and see what God has done in the past. After all, hindsight is 20/20. Do you have a vision of what God can do in your future, and in the future of the church? What do you want to see happening in our church at the end of 2020? How can you present yourself to God so that God can work through you to make it happen? Or will we stagnate in memories of the past, or complacency in the present?

Proverbs 29:18 has something to say about having vision. In the Message, that verse says, "If people can't see what God is doing, they stumble all over themselves." If we can't see God's activity in our lives, and in the life of our church, we surely have a vision problem.

I pray that 2020 will be a year in which we recognize and praise God for what God is already doing in our midst. I also pray that it is a year in which we share our visions for our church and present ourselves to one another and to God, with the question in mind, "How can I be a part of not only the vision, but the fulfillment of the vision?" Can you see it?

Grace and peace,

Pastor Marvin

YOUTH and CHILDREN'S MINISTRY

Jesus and Me, Middle School and High School YOUTH Groups

J.A.M. 4 years old through 4th Grade	4:00 P.M.
5th and 6th Grade Middle School Group	4:00 P.M.
7th and 8th Grade Middle School Group	6:00 P.M.
High School Group	7:15 P.M.



Continue to PRAY FOR OUR CHILDREN, OUR TEENS, OUR TEACHERS, OUR LEADERS, AND OUR FAMILIES AS WE MAKE THIS FAITH JOURNEY TOGETHER.

God's Best Blessings,

Miss Carol



Bring a sack lunch
(finger foods)

\$5 for each child

from 10:00 a.m. - 1:00 p.m.

Ladies Bible Study Group

On Wednesday January 8 at 10:00 a.m.
in the Heritage Room, a video study
by Priscilla Shirer, *The Armor of God*

Contact Peggy Ellison at 620 770-0469. Leave a message.

PRISCILLA SHIRER

The Armor of God



QUILTING GROUP

The Methodist Quilters are almost caught up. If you have a quilt top you would like to have finished, please call Jean Bailey, June Daughetee, Marilyn Kennedy or Priscilla White.



Men of Faith

January 4 & 18 at 7:30 a.m.

Fellowship Hall

Breakfast, Devotions, Discussion

PRATT FUMC SCHOLARSHIP AWARDS FOR SPRING SEMESTER
Attention: High School Graduates & College Students

Applications for Pratt FUMC scholarship awards for the Spring Semester 2020 are available and must be submitted online at www.prattumc.org.

1. Look under the “Youth” tab and click on “Scholarship.”
2. You will need to click two places: one for Scholarship Application Instructions and one to fill out the actual scholarship application on-line.

If you are a member of the Pratt First United Methodist Church, you are eligible to apply. Please follow the application directions carefully, complete the application on-line and submit requested materials to the church office by **January 14, 2020**. The Scholarship Committee awarded \$1000 to each student who qualified for the scholarship this past semester. The Committee will meet to review the completed applications in January and inform the applicants whether or not they have been granted a scholarship.

Mark Ploger, Past Chairman, Scholarship Committee

Seeking a Master's of Divinity?

The Pratt First United Methodist Church Endowment Committee would like to help you financially in reaching this goal. This committee is very aware of the need for additional ministers in our Great Plains Conference and of the cost of seminary education. Each year this committee places funds in a Seminary Scholarship. This fund continues to grow until a member of our church makes the committee aware that they are in seminary and requests funds to help them. A person interested should contact the church office at (620) 672-6473. Please leave your name, phone number and address. The office will notify Joyce Frazier, Chair of the Endowment Committee.

The Endowment Committee was pleased to award the Seminary Scholarship to Chelsea Shrack while she attended Garrett-Evangelical Theological Seminary in Evanston, Illinois. She received the Master of Divinity Degree and has returned to the Great Plains Conference serving K-State Wesley as campus pastor since July 1, 2017.

Attending College/ University/Technical School in 2020?

Our church is asking all Pratt First United Methodist Church members or friends, who plan to attend college/ university or technical school, to complete the information below and return it to the church office, to Eunice Proctor or to Brenda Fowler as soon as possible. Please provide the information no later than the start of the semester. If you live in a dorm you may not be able to provide that address until you move in.

We also wish to display your photo with other college students in the hallway south of fellowship hall. We are asking students to provide a portrait billfold size photo (2 5/8 in. wide x 3 5/16 in. high) on photo paper for this display. This size is necessary for placement in the display board. Please leave the photo in the church office, give to Eunice Proctor or give to Brenda Fowler.

Or you may email a portrait photo to Brenda Fowler @brenfowler@sctelcom.net.

To keep our college students in our thoughts and prayers, a church member will be designated as a prayer partner for each student who provides the requested information. The prayer partner will pray for the student daily and contact them by mail or e-mail. They may also remember you on your birthday and during final exams. We are interested in you and wish you well. You are encouraged to answer contacts from your prayer partner.

Eunice Proctor, 1326 E. Third St., Pratt, 672-5464, ek-proctor@sbcglobal.net

Brenda Fowler, 20351 SE 20th Ave., Pratt, 450-7517, brenfowler@sctelcom.net

Student Information

Name _____

Name of College/University/Technical School _____

School residence address _____

e-mail address _____

Date of Birth _____

Phone Number where you can be reached this summer: cell phone _____

Parent's phone _____

Parent's name _____

HAPPY BIRTHDAY

January 1 Thomas Galle
January 1 Michelle Schmidt
January 2 Barbara Harris
January 2 Betty Onstott
January 4 Katie Buhler
January 4 Ellen Hair
January 5 Ian Clarkson
January 5 Tracy Trimpe
January 6 Nancy Bailey
January 6 Ronnie Prater
January 6 Sharon Winklepleck
January 7 Carol Green
January 7 Ron Ingram
January 8 Kendyl Hanvey
January 8 Tom Post
January 8 Caiden Smiley
January 8 Kaidie Winklepleck
January 8 Deb Withers

January 9 Cade Clarkson
January 9 Kale Wilson
January 10 Kent Goyen
January 11 Marvin Proctor
January 15 Gale Carroll
January 15 Genny Schmidt
January 16 Rosalie Rose
January 17 Jordan Garrett
January 18 Peyton Peissig
January 19 Gina Bates
January 19 Reagan Blasi
January 21 Delaney Skaggs
January 22 Ryan Jarmer
January 23 Noah Malone

January 23 Lu Sherer
January 24 Betty Jean Baus
January 24 Eunice Proctor
January 24 Dontez Ruiz
January 24 Rich Sanders
January 24 Tonya Younie
January 25 Sherri Ewertt
January 25 Joe Kendall
January 25 Cara Riffey
January 25 Denise Sanders
January 26 Janie Bishop
January 26 Kendra Elliot
January 27 Elizabet Ingles
January 28 Vicki Howell
January 28 Ronald Prater
January 30 Eli Battin
January 30 Jim Bergner
January 30 Ashley Fitzsimmons



HAPPY ANNIVERSARY

January 27 Kendra & Scott Elliot

*Make God
Part of 2020*



John 14:12-14

Very truly I tell you, whoever believes in me will do the works I have been doing, and they will do even greater things than these, because I am going to the Father. And I will do whatever you ask in my name, so that the Father may be glorified in the Son. You may ask me for anything in my name, and I will do it.

January Calendar

If you have something that you would like to put in The Spire, please email Jane Bolen jane.bolen@yahoo.com or call her at 620 770-2110 by the 20th of the month before the next Spire.

December 2019	January 2020	February 2020
S M T W T F S 1 2 3 4 5 6 7	S M T W T F S 1 2 3 4	S M T W T F S 1
8 9 10 11 12 13 14	5 6 7 8 9 10 11	2 3 4 5 6 7 8
15 16 17 18 19 20 21	12 13 14 15 16 17 18	9 10 11 12 13 14 15
22 23 24 25 26 27 28	19 20 21 22 23 24 25	16 17 18 19 20 21 22
29 30 31	26 27 28 29 30 31	23 24 25 26 27 28 29

29	30	31	1	2	3	4
	12:00 PM Office Closed at noon	No Activities Office Closed New Year's Day			7:30 AM Men of Faith	
5	6	7	8	9	10	11
7:00 PM Boy Scouts			Wednesday Activities Resume 5:00 PM Snack Supper 6:00 PM Women's Bible Study 7:00 PM Trustees Committee Meeting	12:30 PM UMW General Meeting 2:00 PM UMW Executive Committee	10:00 AM Mom's Day Out, 10:00-1:00	6:00 PM Pitch Party
12	13	14	15	16	17	18
	Scholdship Applications Due 5:15 PM Endowment Committee Meeting	5:00 PM Snack Supper 7:00 PM Rebecca Guild		8:30 AM Sarah Guild 9:30 AM Naomi Guild	10:00 AM Mom's Day Out, 10:00-1:00	7:30 AM Men of Faith
19	20	21	22	23	24	25
7:00 PM Boy Scouts	Martin Luther King, Jr. Day		5:00 PM Snack Supper		10:00 AM Mom's Day Out, 10:00-1:00	
26	27	28	29	30	31	1
			5:00 PM Snack Supper		10:00 AM Mom's Day Out, 10:00-1:00	

WEEKLY EVENTS

SUNDAY SERVICE TIMES

WORSHIP/FELLOWSHIP HALL AT 8:15 A.M.

WORSHIP/SANCTUARY AT 10:30 A.M.

Join us for Sunday School at 9:15 a.m.

MONDAYS

Quilters 9:30 a.m.
Monday Morning Moms 10:00 a.m.

WEDNESDAYS

Ladies' Prayer Group 7:30 a.m.
Ladies Bible Study 10:00 a.m.
J.A.M. 4:00 p.m.
Youth-5th & 6th Grade 4:00 p.m.

Puppets 5:30 p.m.
Snack Supper 5:00 p.m.
Ladies' Bible Study 6:00 p.m.
Youth Group-7th & 8th grade 6:00 p.m.
Praise Band 6:30 p.m.
Youth Group (High School) 7:15 p.m.

FRIDAYS

Mom's Day Out 10:00 a.m.

Join
DEVOHUB
provided by
Pratt FUMC

5
EASY STEPS
to your daily
devotionals

created by
LifeWay



COME TO CHURCH
Come to church with your favorite mobile device

GET THE APP
Go to the Apple, Google Play, or Kindle Fire app stores, search for "DevoHub" and download the app

SELECT ACTIVATE
The app will discover where you are - all you have to do is select "activate"

FULL ACCESS
You now have access to daily devotional content from multiple sources any time, anywhere

Quietud **SIAO FIRM**
-ft OmJOURNEY EES renewdaily
DOWS **ESSENTIAL CONNECTION**

DIG IN

**ENJOY NEW BOOKS
IN THE CHURCH LIBRARY**

We have more new books in the Church Library that we hope you will enjoy.

Two of them are by Pratt authors. *The Dream* by Dr. Shirley Ibeawuchi and *Simple* by Amy Clarkson donated by Mildred Riley.

The 50-50 Sunday School class has donated *A Silken Thread* in memory of Marge Gillig. This is a novel by Kim Sawyer who is a Kansas author.

We also have *Angels* in memory of Shirley Boots and Dave Ramsey and *Finances* in memory of Helen Lake.

Sarah Guild has donated *Lies Women Believe* in memory of Helen Lake and *We Are the Gardeners* in memory of Helen Miller.

If you have a type of book that you would like to have in our library, please call Sharon Brehm, Marilyn Kennedy or Ginny Houdyshell.

NOW AVAILABLE!

Go to: www.prattumc.org

Click on the **ONLINE GIVING** tab and create your profile. Mobile app also available. "GivePlus" is the free download on Google Playstore / Also available at iPhone App Store

GIVE ONLINE

First United Methodist Church
The Spire
P. O. Box 316
100 N. Jackson
Pratt, KS 67124

Phone: (620) 672-6473
Pastor Marvin's cell (316) 655-1716
email: jjohnson@prattumc.org
Web site: www.prattumc.org

Office Hours:
8:00 a.m. – 12:00 p.m.
1:00 p.m. – 5:00 p.m.
Friday 8:00 a.m.-12:00 p.m.



You may pick up your copy of *The Spire* at the church. If you wish to have your name added to the email list, please advise Jacqueline jjohnson@prattumc.org or Jane Bolen jane.bolen@yahoo.com of your address.

Staff

Pastor.....Marvin Ewertt
Business ManagerJacqueline Johnson
Facilities Coordinator..... Louis Keeling
Children & Youth Ministries..... Carol Green
Audio/Video Coordinator.....Sherri Ewertt
Organist/Pianist.....Jane Biles
Praise Band Director Don Buhler
Nursery.....Georgie Fowler